

SERRAMENTI

1A kg. ml. 1,72

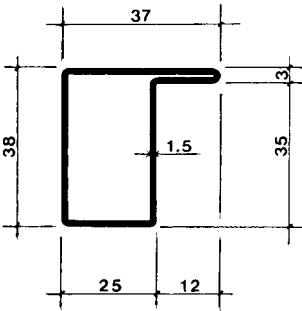

11A kg. ml. 1,34

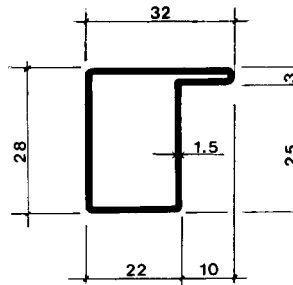

2A kg. ml. 1,76

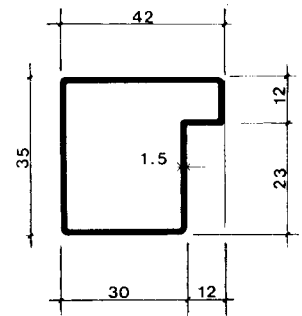

1B kg. ml. 2,10

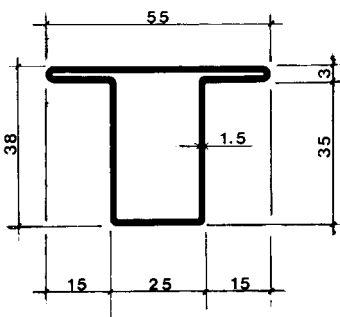

11B kg. ml. 1,57

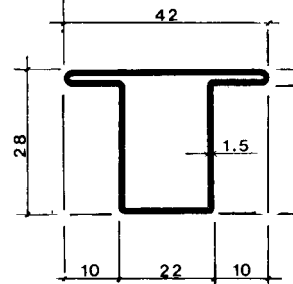

2B kg. ml. 1,88

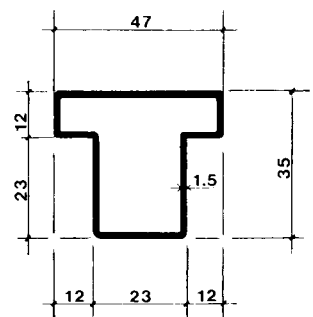

1C kg. ml. 1,99

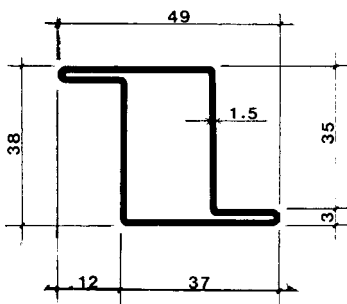

11C kg. ml. 1,57

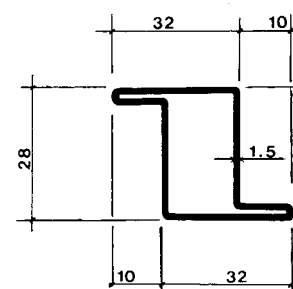

16A SP. 1.5 = kg. ml. 2,33
SP. 2 = kg. ml. 3,08

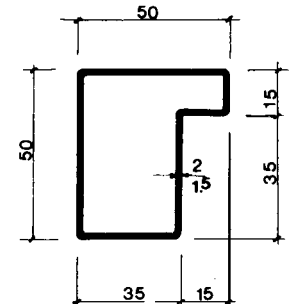

MT 5 SP 1,65

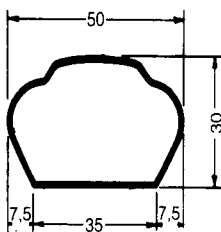

16 D kg. ml. 4,65

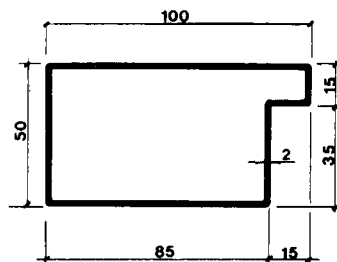

16B SP. 1.5 = kg. ml. 2,33
SP. 2 = kg. ml. 3,08

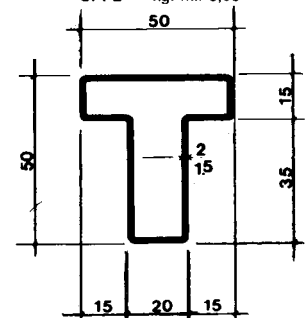

15A kg. ml. 2,04

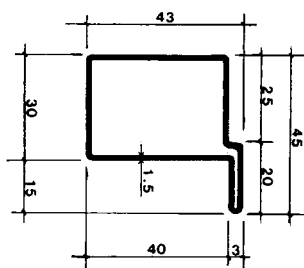

SF1 B kg. ml. 2,15

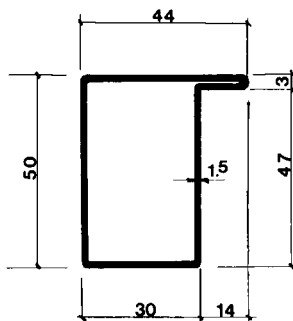

15T kg. ml. 2,45

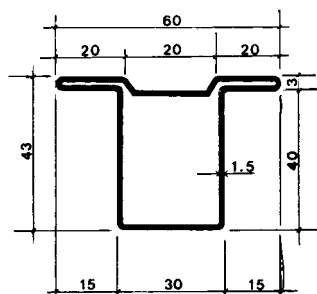

SF2 B kg. ml. 2,52

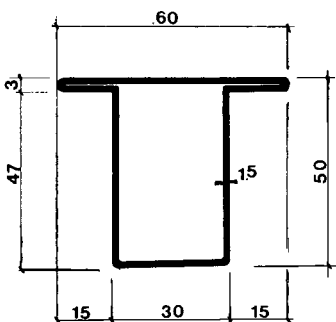

15Z kg. ml. 2,45

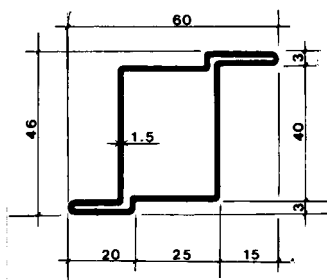

SF3 B kg. ml. 2,52

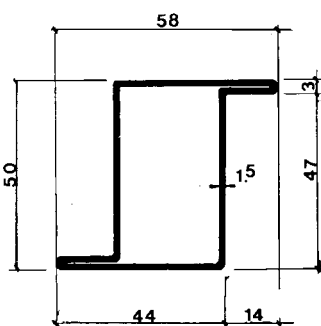

16Z SP. 1,5 = kg. ml. 2,56
SP. 2 = kg. ml. 3,39

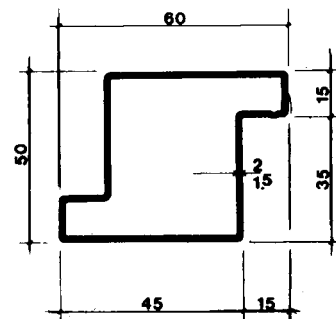

40 A SP 2,280

